



ATW C series

Hydraulic Torque Tool System

ATW C SERIES Interchangeable system for confined spaces...

- Lightweight alloy construction
- Max operating pressure: 10,000 psi (690 Bar)

Option A:
Cartridge Unit plus
Spanners/Cassette

Option B:
Hexagon Head Unit
(See ATWH model on pages 2 & 3).



Option B



Option A



Cartridge Unit



Options...

ATW CO Open Spanner



See tables on page 5 for dimensions and details

ATW CR Ratchet Cassette



See tables on page 6 for dimensions and details

ATW CS Closed Spanner



See tables on page 7 for dimensions and details

ATW CO Open Spanner

Please note: The data in column 'B' is not confirmed. It will depend upon the customers application and confirmed final torque value.

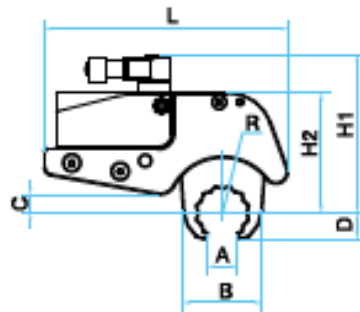

Imperial

Model	Nut Size	2 ATW CO Open Spanner Dimensions (Inch)										
	Imperial	A	B	C	D	R	H1	H2	W1	W2	L	
2ATW CO 1 1/8"	1 1/8"	0.79	1.83		0.51							
2ATW CO 1 1/4"	1 1/4"	0.87	2.36		0.67							
2ATW CO 1 3/8"	1 3/8"	1.00	2.66		0.79							
2ATW CO 1 1/2"	1 1/2"	1.10	3.05	0.49	0.95	1.46	4.94	3.46	0.77	1.26	7.44	
2ATW CO 1 3/4"	1 3/4"	1.22	3.27		1.06							
2ATW CO 2"	2"	1.34	3.46		1.22							
2ATW CO 2 1/4"	2 1/4"	1.44	3.68		1.34							

Metric

Model	Nut Size	2 ATW CO Open Spanner Dimensions (mm)										
	Metric (mm)	A	B	C	D	R	H1	H2	W1	W2	L	
2ATW CO 27	27	20	46		13							
2ATW CO 32	32	22	60		17							
2ATW CO 36	36	25	68		20							
2ATW CO 41	41	28	77	12	24	37	125	88	20	32	189	
2ATW CO 46	46	31	83		27							
2ATW CO 50	50	34	89		31							
2ATW CO 55	55	37	93		34							

Model	Nut Size	4 ATW CO Open Spanner Dimensions (Inch)										
	Imperial	A	B	C	D	R	H1	H2	W1	W2	L	
4ATW CO 1 1/2"	1 1/2"	1.10	2.95		1.04							
4ATW CO 1 3/4"	1 3/4"	1.22	3.34		1.14							
4ATW CO 2"	2"	1.34	3.55		1.24							
4ATW CO 2 1/4"	2 1/4"	1.44	3.90		1.33							
4ATW CO 2 1/2"	2 1/2"	1.62	4.26	0.91	1.45	2.05	6.77	4.80	1.02	1.70	9.76	
4ATW CO 2 3/4"	2 3/4"	1.69	4.61		1.54							
4ATW CO 3"	3"	1.82	4.83		1.66							
4ATW CO 3 1/4"	3 1/4"	1.95	5.06		1.78							

Model	Nut Size	4 ATW CO Open Spanner Dimensions (mm)										
	Metric (mm)	A	B	C	D	R	H1	H2	W1	W2	L	
4ATW CO 41	41	28	75		26							
4ATW CO 46	46	31	85		29							
4ATW CO 50	50	34	90		32							
4ATW CO 55	55	37	99		34	52	172	122	26	43	248	
4ATW CO 60	60	41	108	23	37							
4ATW CO 65	65	43	117		39							
4ATW CO 70	70	46	123		42							
4ATW CO 75	75	50	128		45							

Model	Nut Size	8 ATW CO Open Spanner Dimensions (Inch)										
	Imperial	A	B	C	D	R	H1	H2	W1	W2	L	
8ATW CO 2"	2"	1.34	3.41		1.16							
8ATW CO 2 1/4"	2 1/4"	1.44	3.74		1.27							
8ATW CO 2 1/2"	2 1/2"	1.62	4.09		1.39							
8ATW CO 2 3/4"	2 3/4"	1.69	4.51		1.54							
8ATW CO 3"	3"	1.82	4.85	0.94	1.68	2.64	7.74	5.77	1.30	2.09	11.73	
8ATW CO 3 1/4"	3 1/4"	1.95	5.28		1.75							
8ATW CO 3 1/2"	3 1/2"	2.08	5.61		1.87							
8ATW CO 3 3/4"	3 3/4"	2.23	5.84		2.05							
8ATW CO 4"	4"	2.38	6.07		2.13							

Model	Nut Size	8 ATW CO Open Spanner Dimensions (mm)										
	Metric (mm)	A	B	C	D	R	H1	H2	W1	W2	L	
8ATW CO 50	50	34	87		28							
8ATW CO 55	55	37	95		32							
8ATW CO 60	60	41	104		35							
8ATW CO 65	65	43	114		39							
8ATW CO 70	70	46	123	24	43	67	197	147	33	53	298	
8ATW CO 75	75	50	134		44							
8ATW CO 80	80	53	142		47							
8ATW CO 85	85	57	148		52							
8ATW CO 90	90	61	154		54							

Model	Nut Size	14 ATW CO Open Spanner Dimensions (Inch)										
	Imperial	A	B	C	D	R	H1	H2	W1	W2	L	
14ATW CO 2 1/2"	2 1/2"	1.82	4.72		1.66							
14ATW CO 3"	3"	1.95	5.14		1.77							
14ATW CO 3 1/2"	3 1/2"	2.08	5.51		1.89							
14ATW CO 4"	4"	2.23	5.99		2.00							
14ATW CO 4 1/2"	4 1/2"	2.38	6.39	1.10	2.14	3.15	8.89	6.92	1.53	2.52	14.53	
14ATW CO 5"	5"	2.54	6.61		2.23							
14ATW CO 5 1/2"	5 1/2"	2.70	6.83		2.37							
14ATW CO 6"	6"	2.86	7.06		2.49							
14ATW CO 6 1/2"	6 1/2"	3.01	7.29		2.60							

Model	Nut Size	14 ATW CO Open Spanner Dimensions (mm)										
	Metric (mm)	A	B	C	D	R	H1	H2	W1	W2	L	
14ATW CO 70	70	46	120		42							
14ATW CO 75	75	50	130		45							
14ATW CO 80	80	53	140		48							
14ATW CO 85	85	57	152		51							
14ATW CO 90	90	61	162	28	54	80	226	176	39	64	369	
14ATW CO 95	95	65	168		57							
14ATW CO 100	100	69	173		60							
14ATW CO 105	105	73	179		63							
14ATW CO 110	110	77	185		66							

Model	Nut Size	30 ATW CO Open Spanner Dimensions (Inch)										
	Imperial	A	B	C	D	R	H1	H2	W1	W2	L	
30ATW CO 3 1/2"	3 1/2"	2.38	6.20		2.15							
30ATW CO 4"	4"	2.69	6.65		2.39							
30ATW CO 4 1/2"	4 1/2"	3.01	7.46		2.62							
30ATW CO 5"	5"	3.27	8.22	1.22	2.78	4.33	10.95	8.99	1.98	3.35	16.73	
30ATW CO 5 1/2"	5 1/2"	3.37	9.06		3.07							
30ATW CO 6"	6"	3.57	9.29		3.19							
30ATW CO 6 1/2"	6 1/2"	3.98	9.74		3.42							

Model	Nut Size	30 ATW CO Open Spanner Dimensions (mm)										
	Metric (mm)	A	B	C	D	R	H1	H2	W1	W2	L	
30ATW CO 90	90	61	158		55							
30ATW CO 100	100	69	169		61							
30ATW CO 110	110	77	190		67							
30ATW CO 115	115	83	209	31	71	110	278	228	50	85	425	
30ATW CO 130	130	86	230		78							
30ATW CO 135	135	91	236		81							
30ATW CO 145	145	101	247		87							

ATW CR Ratchet Cassette

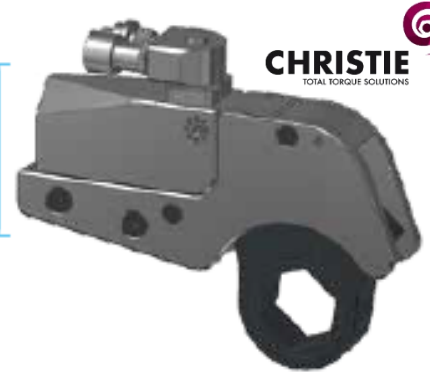
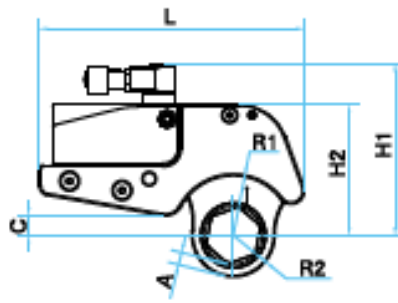

ATW CR RATCHET CASSETTE

Imperial

Metric

Model	Nut Size Imperial	2 ATW CR Ratchet Cassette Dimensions (inch)									
		Torque Ft.Lbs	A	R1	R2	C	H1	H2	W1	W2	L
2ATW CR 1 1/4"	1 1/4"		0.41	1.02							
2ATW CR 1 1/2"	1 1/2"		0.38	1.10							
2ATW CR 1 3/4"	1 3/4"		0.38	1.21							
2ATW CR 1"	1"	143-1,438	0.40	1.46	1.34	0.49	4.94	3.46	0.77	1.26	7.44
2ATW CR 1 1/2"	1 1/2"		0.41	1.46							
2ATW CR 2"	2"		0.39	1.54							
2ATW CR 2 1/2"	2 1/2"		0.38	1.65							

Model	Nut Size Metric (mm)	2 ATW CR Ratchet Cassette Dimensions (mm)									
		Torque Nm	A	R1	R2	C	H1	H2	W1	W2	L
2ATW CR 27	27				26						
2ATW CR 32	32				28						
2ATW CR 36	36				31						
2ATW CR 41	41	194-1,949	10	37	34	12	125	88	20	32	189
2ATW CR 46	46				37						
2ATW CR 50	50				39						
2ATW CR 55	55				42						

Model	Nut Size Imperial	4 ATW CR Ratchet Cassette Dimensions (inch)									
		Torque Ft.Lbs	A	R1	R2	C	H1	H2	W1	W2	L
4ATW CR 1 1/4"	1 1/4"		0.42	1.36							
4ATW CR 1 1/2"	1 1/2"		0.42	1.46							
4ATW CR 2"	2"		0.46	1.61							
4ATW CR 2 1/2"	2 1/2"	372-3,720	0.46	1.72	2.05	0.91	6.77	4.80	1.02	1.70	9.76
4ATW CR 2 3/4"	2 3/4"		0.46	1.83							
4ATW CR 2 1/2"	2 1/2"		0.45	1.93							
4ATW CR 2 3/4"	2 3/4"		0.46	2.05							
4ATW CR 2 1/2"	2 1/2"		0.47	2.17							

Model	Nut Size Metric (mm)	4 ATW CR Ratchet Cassette Dimensions (mm)									
		Torque Nm	A	R1	R2	C	H1	H2	W1	W2	L
4ATW CR 41	41		11	35							
4ATW CR 46	46		11	37							
4ATW CR 50	50		12	41							
4ATW CR 55	55	504-5,044	12	52	44	23	172	122	26	43	248
4ATW CR 60	60		12	46							
4ATW CR 65	65		12	49							
4ATW CR 70	70		12	52							
4ATW CR 75	75		12	55							

Model	Nut Size Imperial	8 ATW CR Ratchet Cassette Dimensions (inch)									
		Torque Ft.Lbs	A	R1	R2	C	H1	H2	W1	W2	L
8ATW CR 2"	2"		0.58	1.73							
8ATW CR 2 1/4"	2 1/4"		0.58	1.84							
8ATW CR 2 1/2"	2 1/2"		0.58	1.95							
8ATW CR 2 3/4"	2 3/4"		0.58	2.06							
8ATW CR 2 1/2"	2 1/2"	678-6,788	0.58	2.64	2.17	0.94	7.74	5.77	1.30	2.09	11.73
8ATW CR 2 3/4"	2 3/4"		0.58	2.28							
8ATW CR 3"	3"		0.60	2.40							
8ATW CR 3 1/4"	3 1/4"		0.62	2.53							
8ATW CR 3 1/2"	3 1/2"		0.63	2.65							

Model	Nut Size Metric (mm)	8 ATW CR Ratchet Cassette Dimensions (mm)									
		Torque Nm	A	R1	R2	C	H1	H2	W1	W2	L
8ATW CR 50	50				44						
8ATW CR 55	55				47						
8ATW CR 60	60				50						
8ATW CR 65	65				52						
8ATW CR 70	70	919-9,204	15	67	55	24	197	147	33	53	298
8ATW CR 75	75				58						
8ATW CR 80	80				61						
8ATW CR 85	85				64						
8ATW CR 90	90				67						

Model	Nut Size Imperial	14 ATW CR Ratchet Cassette Dimensions (inch)									
		Torque Ft.Lbs	A	R1	R2	C	H1	H2	W1	W2	L
14 ATW CR 2 1/2"	2 1/2"		0.72	2.30							
14 ATW CR 2 3/4"	2 3/4"		0.72	2.41							
14 ATW CR 3"	3"		0.72	2.53							
14 ATW CR 3 1/4"	3 1/4"		0.73	2.65							
14 ATW CR 3 1/2"	3 1/2"	1,191-11,918	0.75	3.15	2.78	1.10	8.89	6.92	1.53	2.52	14.53
14 ATW CR 3 3/4"	3 3/4"		0.76	2.89							
14 ATW CR 3"	3"		0.76	3.00							
14 ATW CR 4"	4"		0.65	3.11							
14 ATW CR 4 1/2"	4 1/2"		0.69	3.22							

Model	Nut Size Metric (mm)	14 ATW CR Ratchet Cassette Dimensions (mm)									
		Torque Nm	A	R1	R2	C	H1	H2	W1	W2	L
14 ATW CR 70	70				58						
14 ATW CR 75	75				61						
14 ATW CR 80	80				64						
14 ATW CR 85	85				67						
14 ATW CR 90	90	1,616-16,160	18	80	71	28	226	176	39	64	369
14 ATW CR 95	95				73						
14 ATW CR 100	100				76						
14 ATW CR 105	105				79						
14 ATW CR 110	110				82						

Model	Nut Size Imperial	30 ATW CR Ratchet Cassette Dimensions (inch)									
		Torque Ft.Lbs	A	R1	R2	C	H1	H2	W1	W2	L
30ATW CR 3 1/2"	3 1/2"		1.05	3.07							
30ATW CR 3 3/4"	3 3/4"		1.04	3.27							
30ATW CR 4"	4"		0.98	3.51							
30ATW CR 4 1/2"	4 1/2"	2,616-26,166	1.01	4.33	3.69	1.22	10.95	8.99	1.98	3.35	16.73
30ATW CR 5"	5"		1.00	3.96							
30ATW CR 5 1/2"	5 1/2"		1.01	4.12							
30ATW CR 5 3/4"	5 3/4"		0.97	4.29							

Model	Nut Size Metric (mm)	30 ATW CR Ratchet Cassette Dimensions (mm)									
		Torque Nm	A	R1	R2	C	H1	H2	W1	W2	L
30ATW CR 90	90		26	78							
30ATW CR 100	100		25	83							
30ATW CR 110	110		26	89							
30ATW CR 115	115	3,547-35,481	26	110	94	31	278	228	50	85	425
30ATW CR 130	130		25	101							
30ATW CR 135	135		27	105							
30ATW CR 145	145		25	109							

ATW CS Closed Spanner

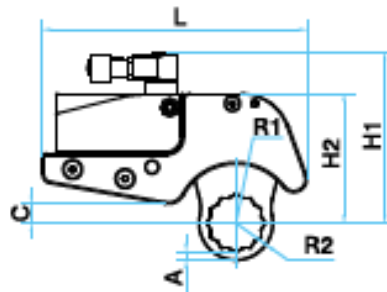

Imperial

2 ATW CS Closed Spanner Dimensions (inch)											
Model	Nut Size Imperial	Torque Ft.Lbs	A	R1	R2	C	H1	H2	W1	W2	L
2ATW CS 1¼"	1¼"				0.86						
2ATW CS 1½"	1½"				0.97						
2ATW CS 1¾"	1¾"				1.08						
2ATW CS 1"	1"	143–1,438	0.25	1.46	1.19	0.49	4.94	3.46	0.77	1.26	7.44
2ATW CS 1½"	1½"				1.30						
2ATW CS 2"	2"				1.40						
2ATW CS 2½"	2½"				1.51						

Metric

2 ATW CS Closed Spanner Dimensions (mm)											
Model	Nut Size Metric (mm)	Torque Nm	A	R1	R2	C	H1	H2	W1	W2	L
2ATW CS 27	27				22						
2ATW CS 32	32				25						
2ATW CS 36	36				27						
2ATW CS 41	41	194–1,949	6	37	30	12	125	88	20	32	189
2ATW CS 46	46				33						
2ATW CS 50	50				36						
2ATW CS 55	55				38						

4 ATW CS Closed Spanner Dimensions (inch)											
Model	Nut Size Imperial	Torque Ft.Lbs	A	R1	R2	C	H1	H2	W1	W2	L
4ATW CS 1½"	1½"				1.27						
4ATW CS 1¾"	1¾"				1.38						
4ATW CS 2"	2"				1.49						
4ATW CS 2½"	2½"	372–3,720	0.33	2.05	1.59	0.91	6.77	4.80	1.02	1.70	9.76
4ATW CS 2¾"	2¾"				1.70						
4ATW CS 2½"	2½"				1.81						
4ATW CS 2¾"	2¾"				1.92						
4ATW CS 2½"	2½"				2.03						

4 ATW CS Closed Spanner Dimensions (mm)											
Model	Nut Size Metric (mm)	Torque Nm	A	R1	R2	C	H1	H2	W1	W2	L
4ATW CS 41	41				32						
4ATW CS 46	46				35						
4ATW CS 50	50				38						
4ATW CS 55	55	504–5,044	8	52	40	23	172	122	26	43	248
4ATW CS 60	60				43						
4ATW CS 65	65				46						
4ATW CS 70	70				49						
4ATW CS 75	75				52						

8 ATW CS Closed Spanner Dimensions (inch)											
Model	Nut Size Imperial	Torque Ft.Lbs	A	R1	R2	C	H1	H2	W1	W2	L
8ATW CS 2"	2"				1.56						
8ATW CS 2½"	2½"				1.67						
8ATW CS 2¾"	2¾"				1.78						
8ATW CS 2½"	2½"				1.89						
8ATW CS 2¾"	2¾"	678–6,788	0.41	2.64	2.00	0.94	7.74	5.77	1.30	2.09	11.73
8ATW CS 2½"	2½"				2.11						
8ATW CS 3"	3"				2.21						
8ATW CS 3½"	3½"				2.35						
8ATW CS 3½"	3½"				2.42						

8 ATW CS Closed Spanner Dimensions (mm)											
Model	Nut Size Metric (mm)	Torque Nm	A	R1	R2	C	H1	H2	W1	W2	L
8ATW CS 50	50				40						
8ATW CS 55	55				42						
8ATW CS 60	60				45						
8ATW CS 65	65				48						
8ATW CS 70	70	919–9,204	10	67	51	24	197	147	33	53	298
8ATW CS 75	75				54						
8ATW CS 80	80				56						
8ATW CS 85	85				60						
8ATW CS 90	90				61						

14 ATW CS Closed Spanner Dimensions (inch)											
Model	Nut Size Imperial	Torque Ft.Lbs	A	R1	R2	C	H1	H2	W1	W2	L
14 ATW CS 2¾"	2¾"				2.09						
14 ATW CS 2¾"	2¾"				2.20						
14 ATW CS 3"	3"				2.30						
14 ATW CS 3½"	3½"				2.44						
14 ATW CS 3½"	3½"	1,066–10,664	0.50	3.15	2.52	1.10	8.89	6.92	1.53	2.52	14.53
14 ATW CS 3¾"	3¾"				2.67						
14 ATW CS 3¾"	3¾"				2.74						
14 ATW CS 4"	4"				2.95						
14 ATW CS 4½"	4½"				3.05						

14 ATW CS Closed Spanner Dimensions (mm)											
Model	Nut Size Metric (mm)	Torque Nm	A	R1	R2	C	H1	H2	W1	W2	L
14ATW CS 70	70				53						
14ATW CS 75	75				56						
14ATW CS 80	80				58						
14ATW CS 85	85				62						
14ATW CS 90	90	1,616–15,160	13	80	64	28	226	176	39	64	369
14ATW CS 95	95				68						
14ATW CS 100	100				70						
14ATW CS 105	105				75						
14ATW CS 110	110				77						

30 ATW CS Closed Spanner Dimensions (inch)											
Model	Nut Size Imperial	Torque Ft.Lbs	A	R1	R2	C	H1	H2	W1	W2	L
30ATW CS 3½"	3½"				2.68						
30ATW CS 3¾"	3¾"				2.90						
30ATW CS 4"	4"				3.19						
30ATW CS 4½"	4½"	2,616–26,166	0.67	4.33	3.38	1.22	10.95	8.99	1.98	3.35	16.73
30ATW CS 5"	5"				3.66						
30ATW CS 5½"	5½"				3.77						
30ATW CS 5¾"	5¾"				3.99						

30 ATW CS Closed Spanner Dimensions (mm)											
Model	Nut Size Metric (mm)	Torque Nm	A	R1	R2	C	H1	H2	W1	W2	L
30ATW CS 90	90				68						
30ATW CS 100	100				74						
30ATW CS 110	110				81						
30ATW CS 115	115	3,547–35,481	17	110	86	31	278	228	50	85	425
30ATW CS 130	130				93						
30ATW CS 135	135				96						
30ATW CS 145	145				101						