



CHRISTIE
TOTAL TORQUE SOLUTIONS

Hydraulic Torque Tools



**REVISED
EDITION
ISSUE 2**



ATWH



IBT



Hispan



Low Profile



Low Height

ATWH

Hydraulic Torque Tool

ATWH HYDRAULIC

With a new lower profile design and lightweight alloy construction, the direct fit ATWH open hexagon hydraulic torque tool is even easier to fit in restricted overhead access situations or on applications with excessive thread protrusion.



Hexagon Reducing Sleeve

Hexagon Head Unit

Release Pin for Torque Tool Body Section and Head Unit

Torque Tool Body Section

Example Bespoke Reactions

Optional extra - manufactured to order



- Lower profile, open hexagon design for direct fit onto the nut or bolt head
- Accuracy within +/-3%
- For use on applications with limited overhead access or with fasteners having excessive thread protrusion
- 360° Swivel Coupler for easy hose alignment
- Head unit accepts hexagon reducing sleeves for use on a range of smaller fasteners
- Quick change head unit with single pin release

See table on opposite page for dimensions and details

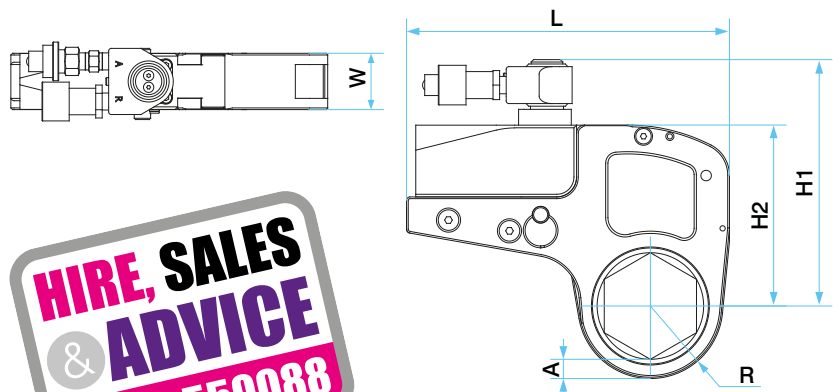

See pages 4 – 7 for interchangeable units for confined spaces.

HIRE, SALES & ADVICE
01709 550088

Drive Unit			Interchangeable Cassette Heads (metric)					Drive Unit & Cassette Assembled							
Model	Weight (Kg)	Torque (Nm)	Hex Size (mm)	Radius 'R' (mm)	Wall 'A' (mm)	Average Weight (Kg)	Model Number	Drive Unit and Cassette Dimensions (mm)							
								L	H1	H2	W				
08 ATWH	0.7	113-1128	30 36	26 29	8 8	0.8	08ATWH-30 08ATWH-36	150	115	77	26				
2 ATWH	0.9	225-2,255	19	27	16	1.5	2ATWH-19	186	132	95	32				
			22	27	14		2ATWH-22								
			27	27	11		2ATWH-27								
			30	29	12		2ATWH-30								
			32	29	11		2ATWH-32								
			34	31	11		2ATWH-34								
			36	31	10		2ATWH-36								
			41	34	10		2ATWH-41								
			46	37	10		2ATWH-46								
			50	40	11		2ATWH-50								
		55	43	11		2ATWH-55									
		233-2,338	60	46	11		2ATWH-60	186	135	98	32				
4 ATWH	1.6	520-5,208	34	36	16	3.4	4ATWH-34	245	176	127	43.5				
			36	36	15		4ATWH-36								
			41	39	15		4ATWH-41								
			46	42	15		4ATWH-46								
			50	44	15		4ATWH-50								
			55	46	14		4ATWH-55								
			60	50	15		4ATWH-60								
			65	53	15		4ATWH-65								
		575-5,755	70	56	15		4ATWH-70	245	186	137	43.5				
			75	59	15		4ATWH-75								
			80	61	15		4ATWH-80								
			41	46	22		8ATWH-41					308	211	154	53
			46	46	19		8ATWH-46								
			50	46	17		8ATWH-50								
55	50	18	8ATWH-55												
60	52	17	8ATWH-60												
65	55	17	8ATWH-65												
70	58	17	8ATWH-70												
75	60	17	8ATWH-75												
80	63	16	8ATWH-80												
85	66	16	8ATWH-85												
90	69	17	8ATWH-90												
95	71	16	8ATWH-95												
1,123-11,233	100	75	17	8ATWH-100	308	220	163	53							
	105	78	17	8ATWH-105											
14 ATWH	4.8	1,852-18,521	50	60	31	11.4	14ATWH-50	378	252	200	64				
			55	60	28		14ATWH-55								
			60	60	25		14ATWH-60								
			65	60	22		14ATWH-65								
			70	60	19		14ATWH-70								
			75	63	19		14ATWH-75								
			80	66	19		14ATWH-80								
			85	69	19		14ATWH-85								
			90	72	20		14ATWH-90								
			95	74	19		14ATWH-95								
			100	77	19		14ATWH-100								
			105	80	19		14ATWH-105								
			110	83	19		14ATWH-110								
			115	87	20		14ATWH-115								
117	87	19	14ATWH-117												
30 ATWH	10.5	4,188-41,882	85	78	28	20.5	30ATWH-85	460	300	253	85				
			90	78	27		30ATWH-90								
			95	83	28		30ATWH-95								
			100	83	25		30ATWH-100								
			105	89	28		30ATWH-105								
			110	89	25		30ATWH-110								
			115	95	28		30ATWH-115								
			117	95	27		30ATWH-117								
			120	95	25		30ATWH-120								
			125	101	29		30ATWH-125								
			130	101	26		30ATWH-130								
			135	104	26		30ATWH-135								
			140	110	29		30ATWH-140								
			145	110	26		30ATWH-145								
		150	116	29	30ATWH-150										
		155	116	26	30ATWH-155										
		4,459-44,593	160	128	36		30ATWH-160	460	313	266	85				
			165	128	33		30ATWH-165								
			170	128	30		30ATWH-170								
			175	128	27		30ATWH-175								

ATW C series

Hydraulic Torque Tool System

ATW C SERIES Interchangeable system for confined spaces...

- Lightweight alloy construction
- Max operating pressure: 10,000 psi (690 Bar)

Option A:
Cartridge Unit plus
Spanners/Cassette

Option B:
Hexagon Head Unit
(See ATWH model on pages 2 & 3).

Torque Tool
Body Section



Option B



Hexagon
Head Unit

Option A

Cartridge
Unit

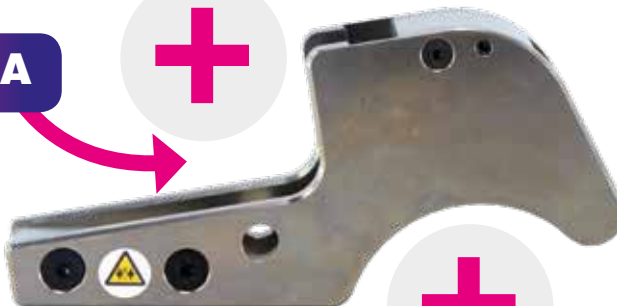

**HIRE, SALES
& ADVICE**
01709 550088

Options...

ATW CO Open Spanner



See tables
on page 5 for
dimensions
and details

ATW CR Ratchet Cassette



See tables
on page 6 for
dimensions
and details

ATW CS Closed Spanner



See tables
on page 7 for
dimensions
and details

ATW CO Open Spanner

Please note: The data in column 'B' is not confirmed. It will depend upon the customers application and confirmed final torque value.

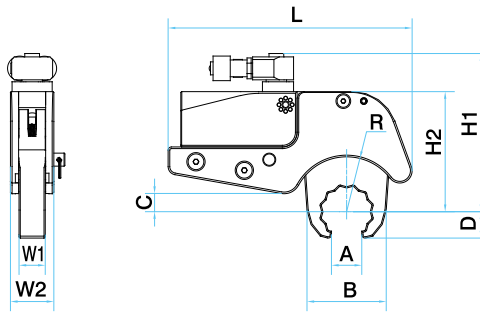

ATW CO OPEN SPANNER

Imperial

Model	Nut Size Imperial	2 ATW CO Open Spanner Dimensions (inch)													
		A	B	C	D	R	H1	H2	W1	W2	L				
2ATW CO 1 1/16"	1 1/16"	0.79	1.83		0.51										
2ATW CO 1 1/4"	1 1/4"	0.87	2.36		0.67										
2ATW CO 1 7/16"	1 7/16"	1.00	2.66		0.79										
2ATW CO 1 1/2"	1 1/2"	1.10	3.05	0.49	0.95	1.46	4.94	3.46	0.77	1.26	7.44				
2ATW CO 1 3/4"	1 3/4"	1.22	3.27		1.06										
2ATW CO 2"	2"	1.34	3.46		1.22										
2ATW CO 2 3/16"	2 3/16"	1.44	3.68		1.34										

Metric

Model	Nut Size Metric (mm)	2 ATW CO Open Spanner Dimensions (mm)													
		A	B	C	D	R	H1	H2	W1	W2	L				
2ATW CO 27	27	20	46		13										
2ATW CO 32	32	22	60		17										
2ATW CO 36	36	25	68		20										
2ATW CO 41	41	28	77	12	24	37	125	88	20	32	189				
2ATW CO 46	46	31	83		27										
2ATW CO 50	50	34	88		31										
2ATW CO 55	55	37	93		34										

Model	Nut Size Imperial	4 ATW CO Open Spanner Dimensions (inch)													
		A	B	C	D	R	H1	H2	W1	W2	L				
4ATW CO 1 1/8"	1 1/8"	1.10	2.95		1.04										
4ATW CO 1 1/4"	1 1/4"	1.22	3.34		1.14										
4ATW CO 1 1/2"	1 1/2"	1.34	3.55		1.24										
4ATW CO 1 3/4"	1 3/4"	1.44	3.90		1.33										
4ATW CO 2"	2"	1.62	4.26	0.91	1.45	2.05	6.77	4.80	1.02	1.70	9.76				
4ATW CO 2 1/8"	2 1/8"	1.69	4.61		1.54										
4ATW CO 2 1/4"	2 1/4"	1.82	4.83		1.66										
4ATW CO 2 1/2"	2 1/2"	1.95	5.06		1.78										

Model	Nut Size Metric (mm)	4 ATW CO Open Spanner Dimensions (mm)													
		A	B	C	D	R	H1	H2	W1	W2	L				
4ATW CO 41	41	28	75		26										
4ATW CO 46	46	31	85		29										
4ATW CO 50	50	34	90		32										
4ATW CO 55	55	37	99		34										
4ATW CO 60	60	41	108	23	37	52	172	122	26	43	248				
4ATW CO 65	65	43	117		39										
4ATW CO 70	70	46	123		42										
4ATW CO 75	75	50	128		45										

Model	Nut Size Imperial	8 ATW CO Open Spanner Dimensions (inch)													
		A	B	C	D	R	H1	H2	W1	W2	L				
8ATW CO 2"	2"	1.34	3.41		1.16										
8ATW CO 2 3/16"	2 3/16"	1.44	3.74		1.27										
8ATW CO 2 3/8"	2 3/8"	1.62	4.09		1.39										
8ATW CO 2 1/2"	2 1/2"	1.69	4.51		1.54										
8ATW CO 2 3/4"	2 3/4"	1.82	4.85	0.94	1.68	2.64	7.74	5.77	1.30	2.09	11.73				
8ATW CO 2 15/16"	2 15/16"	1.95	5.28		1.75										
8ATW CO 3 1/8"	3 1/8"	2.08	5.61		1.87										
8ATW CO 3 1/2"	3 1/2"	2.23	5.84		2.05										
8ATW CO 3 1/2"	3 1/2"	2.38	6.07		2.13										

Model	Nut Size Metric (mm)	8 ATW CO Open Spanner Dimensions (mm)													
		A	B	C	D	R	H1	H2	W1	W2	L				
8ATW CO 50	50	34	87		28										
8ATW CO 55	55	37	95		32										
8ATW CO 60	60	41	104		35										
8ATW CO 65	65	43	114		39										
8ATW CO 70	70	46	123	24	43	67	197	147	33	53	298				
8ATW CO 75	75	50	134		44										
8ATW CO 80	80	53	142		47										
8ATW CO 85	85	57	148		52										
8ATW CO 90	90	61	154		54										

Model	Nut Size Imperial	14 ATW CO Open Spanner Dimensions (inch)													
		A	B	C	D	R	H1	H2	W1	W2	L				
14ATW CO 2 3/4"	2 3/4"	1.82	4.72		1.66										
14ATW CO 2 15/16"	2 15/16"	1.95	5.14		1.77										
14ATW CO 3 1/8"	3 1/8"	2.08	5.51		1.89										
14ATW CO 3 1/2"	3 1/2"	2.23	5.99		2.00										
14ATW CO 3 1/2"	3 1/2"	2.38	6.39	1.10	2.14	3.15	8.89	6.92	1.53	2.52	14.53				
14ATW CO 3 15/16"	3 15/16"	2.54	6.61		2.23										
14ATW CO 3 7/8"	3 7/8"	2.70	6.83		2.37										
14ATW CO 4 1/4"	4 1/4"	2.86	7.06		2.49										
14ATW CO 4 3/8"	4 3/8"	3.01	7.29		2.60										

Model	Nut Size Metric (mm)	14 ATW CO Open Spanner Dimensions (mm)													
		A	B	C	D	R	H1	H2	W1	W2	L				
14ATW CO 70	70	46	120		42										
14ATW CO 75	75	50	130		45										
14ATW CO 80	80	53	140		48										
14ATW CO 85	85	57	152		51										
14ATW CO 90	90	61	162	28	54	80	226	176	39	64	369				
14ATW CO 95	95	65	168		57										
14ATW CO 100	100	69	173		60										
14ATW CO 105	105	73	179		63										
14ATW CO 110	110	77	185		66										

Model	Nut Size Imperial	30 ATW CO Open Spanner Dimensions (inch)													
		A	B	C	D	R	H1	H2	W1	W2	L				
30ATW CO 3 1/2"	3 1/2"	2.38	6.20		2.15										
30ATW CO 3 7/8"	3 7/8"	2.69	6.65		2.39										
30ATW CO 4 1/8"	4 1/8"	3.01	7.46		2.62										
30ATW CO 4 3/8"	4 3/8"	3.27	8.22	1.22	2.78	4.33	10.95	8.99	1.98	3.35	16.73				
30ATW CO 5 1/8"	5 1/8"	3.37	9.06		3.07										
30ATW CO 5 3/8"	5 3/8"	3.57	9.29		3.19										
30ATW CO 5 3/4"	5 3/4"	3.98	9.74		3.42										

Model	Nut Size Metric (mm)	30 ATW CO Open Spanner Dimensions (mm)													
		A	B	C	D	R	H1	H2	W1	W2	L				
30ATW CO 90	90	61	158		55										
30ATW CO 100	100	69	169		61										
30ATW CO 110	110	77	190		67										
30ATW CO 115	115	83	209	31	71	110	278	228	50	85	425				
30ATW CO 130	130	86	230		78										
30ATW CO 135	135	91	236		81										
30ATW CO 145	145	101	247		87										

ATW CR Ratchet Cassette

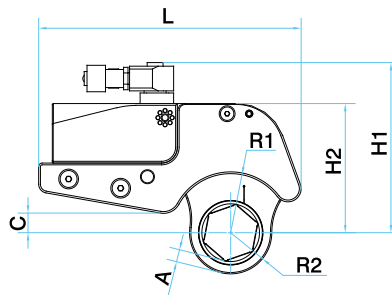
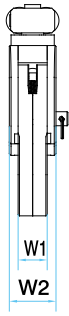

ATW CR RATCHET CASSETTE

Imperial

Model	Nut Size	2 ATW CR Ratchet Cassette Dimensions (inch)									
	Imperial	Torque Ft.lbs	A	R1	R2	C	H1	H2	W1	W2	L
2ATW CR 1 ¹ / ₁₆ "	1 ¹ / ₁₆ "		0.41	1.02							
2ATW CR 1 ¹ / ₄ "	1 ¹ / ₄ "		0.38	1.10							
2ATW CR 1 ¹ / ₂ "	1 ¹ / ₂ "		0.38	1.21							
2ATW CR 1 ³ / ₈ "	1 ³ / ₈ "	143~1,438	0.40	1.46	1.34	0.49	4.94	3.46	0.77	1.26	7.44
2ATW CR 1 ³ / ₁₆ "	1 ³ / ₁₆ "		0.41	1.46							
2ATW CR 2"	2"		0.39	1.54							
2ATW CR 2 ³ / ₁₆ "	2 ³ / ₁₆ "		0.38	1.65							

Metric

Model	Nut Size	2 ATW CR Ratchet Cassette Dimensions (mm)									
	Metric (mm)	Torque Nm	A	R1	R2	C	H1	H2	W1	W2	L
2ATW CR 27	27				26						
2ATW CR 32	32				28						
2ATW CR 36	36				31						
2ATW CR 41	41	194~1,949	10	37	34	12	125	88	20	32	189
2ATW CR 46	46				37						
2ATW CR 50	50				39						
2ATW CR 55	55				42						

Model	Nut Size	4 ATW CR Ratchet Cassette Dimensions (inch)									
	Imperial	Torque Ft.lbs	A	R1	R2	C	H1	H2	W1	W2	L
4ATW CR 1 ¹ / ₈ "	1 ¹ / ₈ "		0.42	1.36							
4ATW CR 1 ³ / ₁₆ "	1 ³ / ₁₆ "		0.42	1.46							
4ATW CR 2"	2"		0.46	1.61							
4ATW CR 2 ³ / ₁₆ "	2 ³ / ₁₆ "	372~3,720	0.46	1.72	2.05	0.91	6.77	4.80	1.02	1.70	9.76
4ATW CR 2 ³ / ₈ "	2 ³ / ₈ "		0.46	1.83							
4ATW CR 2 ⁹ / ₁₆ "	2 ⁹ / ₁₆ "		0.45	1.93							
4ATW CR 2 ³ / ₄ "	2 ³ / ₄ "		0.46	2.05							
4ATW CR 2 ¹ / ₂ "	2 ¹ / ₂ "		0.47	2.17							

Model	Nut Size	4 ATW CR Ratchet Cassette Dimensions (mm)									
	Metric (mm)	Torque Nm	A	R1	R2	C	H1	H2	W1	W2	L
4ATW CR 41	41		11	35							
4ATW CR 46	46		11	37							
4ATW CR 50	50		12	41							
4ATW CR 55	55	504~5,044	12	52	44	23	172	122	26	43	248
4ATW CR 60	60		12	46							
4ATW CR 65	65		12	49							
4ATW CR 70	70		12	52							
4ATW CR 75	75		12	55							

Model	Nut Size	8 ATW CR Ratchet Cassette Dimensions (inch)									
	Imperial	Torque Ft.lbs	A	R1	R2	C	H1	H2	W1	W2	L
8ATW CR 2"	2"		0.58	1.73							
8ATW CR 2 ³ / ₁₆ "	2 ³ / ₁₆ "		0.58	1.84							
8ATW CR 2 ³ / ₈ "	2 ³ / ₈ "		0.58	1.95							
8ATW CR 2 ⁹ / ₁₆ "	2 ⁹ / ₁₆ "		0.58	2.06							
8ATW CR 2 ³ / ₄ "	2 ³ / ₄ "	678~6,788	0.58	2.64	2.17	0.94	7.74	5.77	1.30	2.09	11.73
8ATW CR 2 ¹ / ₂ "	2 ¹ / ₂ "		0.58	2.28							
8ATW CR 3 ¹ / ₈ "	3 ¹ / ₈ "		0.60	2.40							
8ATW CR 3 ¹ / ₁₆ "	3 ¹ / ₁₆ "		0.62	2.53							
8ATW CR 3 ¹ / ₂ "	3 ¹ / ₂ "		0.63	2.65							

Model	Nut Size	8 ATW CR Ratchet Cassette Dimensions (mm)									
	Metric (mm)	Torque Nm	A	R1	R2	C	H1	H2	W1	W2	L
8ATW CR 50	50				44						
8ATW CR 55	55				47						
8ATW CR 60	60				50						
8ATW CR 65	65				52						
8ATW CR 70	70	919~9,204	15	67	55	24	197	147	33	53	298
8ATW CR 75	75				58						
8ATW CR 80	80				61						
8ATW CR 85	85				64						
8ATW CR 90	90				67						

Model	Nut Size	14 ATW CR Ratchet Cassette Dimensions (inch)									
	Imperial	Torque Ft.lbs	A	R1	R2	C	H1	H2	W1	W2	L
14 ATW CR 2 ³ / ₄ "	2 ³ / ₄ "		0.72	2.30							
14 ATW CR 2 ¹ / ₂ "	2 ¹ / ₂ "		0.72	2.41							
14 ATW CR 3 ¹ / ₈ "	3 ¹ / ₈ "		0.72	2.53							
14 ATW CR 3 ¹ / ₁₆ "	3 ¹ / ₁₆ "		0.73	2.65							
14 ATW CR 3 ¹ / ₂ "	3 ¹ / ₂ "	1,191~11,918	0.75	3.15	2.78	1.10	8.89	6.92	1.53	2.52	14.53
14 ATW CR 3 ¹ / ₄ "	3 ¹ / ₄ "		0.76	2.89							
14 ATW CR 3 ³ / ₈ "	3 ³ / ₈ "		0.76	3.00							
14 ATW CR 4 ¹ / ₄ "	4 ¹ / ₄ "		0.65	3.11							
14 ATW CR 4 ³ / ₈ "	4 ³ / ₈ "		0.69	3.22							

Model	Nut Size	14 ATW CR Ratchet Cassette Dimensions (mm)									
	Metric (mm)	Torque Nm	A	R1	R2	C	H1	H2	W1	W2	L
14 ATW CR 70	70				58						
14 ATW CR 75	75				61						
14 ATW CR 80	80				64						
14 ATW CR 85	85				67						
14 ATW CR 90	90	1,616~16,160	18	80	71	28	226	176	39	64	369
14 ATW CR 95	95				73						
14 ATW CR 100	100				76						
14 ATW CR 105	105				79						
14 ATW CR 110	110				82						

Model	Nut Size	30 ATW CR Ratchet Cassette Dimensions (inch)									
	Imperial	Torque Ft.lbs	A	R1	R2	C	H1	H2	W1	W2	L
30ATW CR 3 ¹ / ₂ "	3 ¹ / ₂ "		1.05	3.07							
30ATW CR 3 ³ / ₈ "	3 ³ / ₈ "		1.04	3.27							
30ATW CR 4 ³ / ₈ "	4 ³ / ₈ "		0.98	3.51							
30ATW CR 4 ¹ / ₂ "	4 ¹ / ₂ "	2,616~26,166	1.01	4.33	3.69	1.22	10.95	8.99	1.98	3.35	16.73
30ATW CR 5 ¹ / ₈ "	5 ¹ / ₈ "		1.00	3.96							
30ATW CR 5 ³ / ₈ "	5 ³ / ₈ "		1.01	4.12							
30ATW CR 5 ¹ / ₄ "	5 ¹ / ₄ "		0.97	4.29							

Model	Nut Size	30 ATW CR Ratchet Cassette Dimensions (mm)									
	Metric (mm)	Torque Nm	A	R1	R2	C	H1	H2	W1	W2	L
30ATW CR 90	90		26	78							
30ATW CR 100	100		25	83							
30ATW CR 110	110		26	89							
30ATW CR 115	115	3,547~35,481	26	110	94	31	278	228	50	85	425
30ATW CR 130	130		25	101							
30ATW CR 135	135		27	105							
30ATW CR 145	145		25	109							

ATW CS Closed Spanner

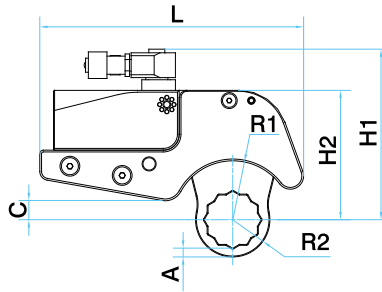
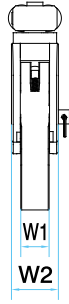

ATW CS CLOSED SPANNER

Imperial

2 ATW CS Closed Spanner Dimensions (inch)											
Model	Nut Size Imperial	Torque Ft.lbs	A	R1	R2	C	H1	H2	W1	W2	L
2ATW CS 1 1/16"	1 1/16"				0.86						
2ATW CS 1 1/4"	1 1/4"				0.97						
2ATW CS 1 7/16"	1 7/16"				1.08						
2ATW CS 1 1/2"	1 1/2"	143~1,438	0.25	1.46	1.19	0.49	4.94	3.46	0.77	1.26	7.44
2ATW CS 1 3/16"	1 3/16"				1.30						
2ATW CS 2"	2"				1.40						
2ATW CS 2 3/16"	2 3/16"				1.51						

Metric

2 ATW CS Closed Spanner Dimensions (mm)											
Model	Nut Size Metric (mm)	Torque Nm	A	R1	R2	C	H1	H2	W1	W2	L
2ATW CS 27	27				22						
2ATW CS 32	32				25						
2ATW CS 36	36				27						
2ATW CS 41	41	194~1,949	6	37	30	12	125	88	20	32	189
2ATW CS 46	46				33						
2ATW CS 50	50				36						
2ATW CS 55	55				38						

4 ATW CS Closed Spanner Dimensions (inch)											
Model	Nut Size Imperial	Torque Ft.lbs	A	R1	R2	C	H1	H2	W1	W2	L
4ATW CS 1 1/8"	1 1/8"				1.27						
4ATW CS 1 3/16"	1 3/16"				1.38						
4ATW CS 2"	2"				1.49						
4ATW CS 2 3/16"	2 3/16"	372~3,720	0.33	2.05	1.59	0.91	6.77	4.80	1.02	1.70	9.76
4ATW CS 2 3/8"	2 3/8"				1.70						
4ATW CS 2 9/16"	2 9/16"				1.81						
4ATW CS 2 3/4"	2 3/4"				1.92						
4ATW CS 2 15/16"	2 15/16"				2.03						

4 ATW CS Closed Spanner Dimensions (mm)											
Model	Nut Size Metric (mm)	Torque Nm	A	R1	R2	C	H1	H2	W1	W2	L
4ATW CS 41	41				32						
4ATW CS 46	46				35						
4ATW CS 50	50				38						
4ATW CS 55	55	504~5,044	8	52	40	23	172	122	26	43	248
4ATW CS 60	60				43						
4ATW CS 65	65				46						
4ATW CS 70	70				49						
4ATW CS 75	75				52						

8 ATW CS Closed Spanner Dimensions (inch)											
Model	Nut Size Imperial	Torque Ft.lbs	A	R1	R2	C	H1	H2	W1	W2	L
8ATW CS 2"	2"				1.56						
8ATW CS 2 3/16"	2 3/16"				1.67						
8ATW CS 2 3/8"	2 3/8"				1.78						
8ATW CS 2 9/16"	2 9/16"				1.89						
8ATW CS 2 3/4"	2 3/4"	678~6,788	0.41	2.64	2.00	0.94	7.74	5.77	1.30	2.09	11.73
8ATW CS 2 15/16"	2 15/16"				2.11						
8ATW CS 3 1/8"	3 1/8"				2.21						
8ATW CS 3 1/2"	3 1/2"				2.35						
8ATW CS 3 1/2"	3 1/2"				2.42						

8 ATW CS Closed Spanner Dimensions (mm)											
Model	Nut Size Metric (mm)	Torque Nm	A	R1	R2	C	H1	H2	W1	W2	L
8ATW CS 50	50				40						
8ATW CS 55	55				42						
8ATW CS 60	60				45						
8ATW CS 65	65				48						
8ATW CS 70	70	919~9,204	10	67	51	24	197	147	33	53	298
8ATW CS 75	75				54						
8ATW CS 80	80				56						
8ATW CS 85	85				60						
8ATW CS 90	90				61						

14 ATW CS Closed Spanner Dimensions (inch)											
Model	Nut Size Imperial	Torque Ft.lbs	A	R1	R2	C	H1	H2	W1	W2	L
14 ATW CS 2 3/4"	2 3/4"				2.09						
14 ATW CS 2 15/16"	2 15/16"				2.20						
14 ATW CS 3 1/8"	3 1/8"				2.30						
14 ATW CS 3 1/2"	3 1/2"				2.44						
14 ATW CS 3 1/2"	3 1/2"	1,066~10,664	0.50	3.15	2.52	1.10	8.89	6.92	1.53	2.52	14.53
14 ATW CS 3 11/16"	3 11/16"				2.67						
14 ATW CS 3 7/8"	3 7/8"				2.74						
14 ATW CS 4 1/4"	4 1/4"				2.95						
14 ATW CS 4 3/8"	4 3/8"				3.05						

14 ATW CS Closed Spanner Dimensions (mm)											
Model	Nut Size Metric (mm)	Torque Nm	A	R1	R2	C	H1	H2	W1	W2	L
14ATW CS 70	70				53						
14ATW CS 75	75				56						
14ATW CS 80	80				58						
14ATW CS 85	85				62						
14ATW CS 90	90	1,616~16,160	13	80	64	28	226	176	39	64	369
14ATW CS 95	95				68						
14ATW CS 100	100				70						
14ATW CS 105	105				75						
14ATW CS 110	110				77						

30 ATW CS Closed Spanner Dimensions (inch)											
Model	Nut Size Imperial	Torque Ft.lbs	A	R1	R2	C	H1	H2	W1	W2	L
30ATW CS 3 1/2"	3 1/2"				2.68						
30ATW CS 3 7/8"	3 7/8"				2.90						
30ATW CS 4 3/8"	4 3/8"				3.19						
30ATW CS 4 3/4"	4 3/4"	2,616~26,166	0.67	4.33	3.38	1.22	10.95	8.99	1.98	3.35	16.73
30ATW CS 5 1/8"	5 1/8"				3.66						
30ATW CS 5 3/8"	5 3/8"				3.77						
30ATW CS 5 3/4"	5 3/4"				3.99						

30 ATW CS Closed Spanner Dimensions (mm)											
Model	Nut Size Metric (mm)	Torque Nm	A	R1	R2	C	H1	H2	W1	W2	L
30ATW CS 90	90				68						
30ATW CS 100	100				74						
30ATW CS 110	110				81						
30ATW CS 115	115	3,547~35,481	17	110	86	31	278	228	50	85	425
30ATW CS 130	130				93						
30ATW CS 135	135				96						
30ATW CS 145	145				101						

LOW

Hydraulic Torque Tool

LOW HYDRAULIC

With an open hexagon design and alloy lightweight structure the Christie LOW range of hydraulic torque tools fit directly onto the nut or bolt head, making them ideal for use on applications with limited overhead access or with fasteners having excessive thread protrusion.

Storage boxes and trolleys available



- Accuracy within +/-3%
- 360° Swivel Coupler for easy hose alignment
- Head unit accepts hexagon reducing sleeves for use on a range of smaller fasteners
- Change of head unit is quick and easy with single pin release



See table on opposite page for dimensions and details

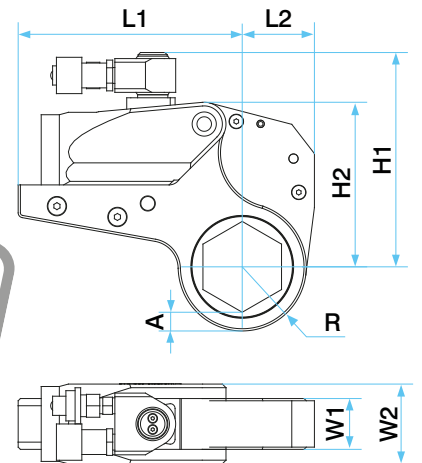

HIRE, SALES & ADVICE
01709 550088



Drive Unit			Interchangeable Cassette Heads (metric)					Drive Unit & Cassette Assembled											
Model	Weight (Kg)	Torque (Nm)	Hex Size (mm)	Radius 'R' (mm)	Wall 'A' (mm)	Average Weight (Kg)	Model Number	Drive Unit and Cassette Dimensions (mm)											
								L1	L2	H1	H2	W1	W2						
2 LOW	1	180-2,230	19	27	16	1.6	2LOW-19	140	46	132	102	32	51						
			22	27	14		2LOW-22												
			27	27	11		2LOW-27												
			30	29	12		2LOW-30												
			32	29	11		2LOW-32												
			34	31	11		2LOW-34												
			36	31	10		2LOW-36												
			41	34	10		2LOW-41												
			46	37	10		2LOW-46												
			50	40	11		2LOW-50												
			55	43	11		2LOW-55												
			60	46	11		1.7							2LOW-60	135	105	32	51	
4 LOW	2	440-5,740	34	36	16	4.4	4LOW-34	185	55	177	136	42	66						
			36	36	15		4LOW-36												
			41	39	15		4LOW-41												
			46	42	15		4LOW-46												
			50	44	15	4.6	4LOW-50		60	187	146	42	66						
			55	46	14		4LOW-55												
			60	50	15		4LOW-60												
			65	53	15		4LOW-65												
			70	56	15		4LOW-70												
			75	59	15		4LOW-75												
			80	61	15		4LOW-80												
			80	61	15		8.4							8LOW-80	184	61	187	146	42
8 LOW	3.3	890-10,200	41	46	22	8	8LOW-41	223	71	209	170	53	83						
			46	46	19		8LOW-46												
			50	46	17		8LOW-50												
			55	50	18		8LOW-55												
			60	52	17		8LOW-60												
			65	55	17		8LOW-65												
			70	58	17		8LOW-70												
			75	60	17		8LOW-75												
			80	63	16		8LOW-80												
			85	66	16		8LOW-85												
			90	69	17		8LOW-90												
			95	71	16		8LOW-95												
100	75	17	8.4	8LOW-100	78	216	177	53	83										
105	78	17		8LOW-105															
14 LOW	5.5	1,852-17,200	50	60	31	11.6	14LOW-50	275	87	236	203	64	99						
			55	60	28		14LOW-55												
			60	60	25		14LOW-60												
			65	60	22		14LOW-65												
			70	60	19		14LOW-70												
			75	63	19		14LOW-75												
			80	66	19		14LOW-80												
			85	69	19		14LOW-85												
			90	72	20		14LOW-90												
			95	74	19		14LOW-95												
			100	77	19		14LOW-100												
			105	80	19		14LOW-105												
110	83	19	14LOW-110																
115	87	20	14LOW-115																
117	87	19	14LOW-117																
30 LOW	11.4	3,500-41,000	85	78	28	29	30LOW-85	313	117	309	272	85	131						
			90	78	27		30LOW-90												
			95	83	28		30LOW-95												
			100	83	25		30LOW-100												
			105	89	28		30LOW-105												
			110	89	25		30LOW-110												
			115	95	28		30LOW-115												
			117	95	27		30LOW-117												
			120	95	25		30LOW-120												
			125	101	29		30LOW-125												
			130	101	26		30LOW-130												
			135	104	26		30LOW-135												
			140	110	29		30LOW-140												
			145	110	26		30LOW-145												
			150	116	29		30LOW-150												
			155	116	26		30LOW-155												
			160	128	36		30							30LOW-160	128	321	285	85	131
			165	128	33		30LOW-165												
170	128	30	30LOW-170																
175	128	27	30LOW-175																

IBT

Hydraulic Torque Tool

IBT HYDRAULIC

With a mono body design and alloy construction, the lightweight IBT torque tool range is perfect for those bolting jobs requiring the use of impact sockets and ancillaries.

- Accuracy within +/-3%
- 360° Swivel Coupler for easy hose alignment
- Single release button mechanism gives quick and easy change of reaction angle
- Push button release on square drive allows rapid change over from bolt tightening to un-tightening
- Square drive is interchangeable with direct fit outputs



Smart Socket

Transducerized hexagonal socket for torque verification on non-impacting square drive torque tools



Refer to page 26 of our Hand Held Torque Tools brochure or visit our website for further details.

Backing Tool (See page 22)

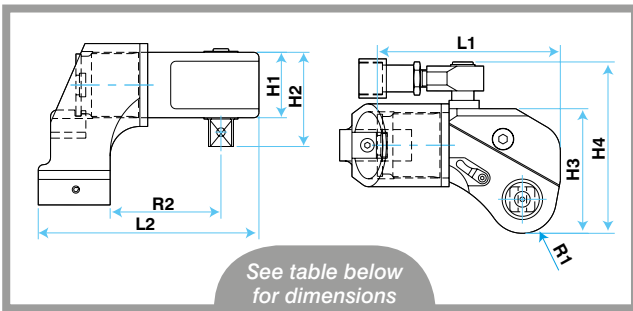

See table below for dimensions and details

Model	Dimensions (mm)								Tool Weight Kg	Torque Range (Nm)		Square Drive
	L1	L2	H1	H2	H3	H4	R1	R2		Min	Max	
07 IBT	111	139	42	66	76.5	108.5	20.5	68	1.8	112	1,070	¾"
1 IBT	140	169	50	72	95	131	26	85	2.5	183	1,755	¾"
3 IBT	175	226	68	96	127	177	34	114	5	451	4,310	1"
5 IBT	207	267	80	123	149	198	39	141	8	752	7,190	1½"
8 IBT	227	294	90	132	167	217	47	154	11	1,078	10,295	1½"
10 IBT	246	318	100	141	181	230	51	154	15	1,551	14,820	1½"
20 IBT	318	385	130	188	220	269	59	185	26.5	2,666	25,465	2½"
25 IBT	333	402	137	200	248	297	66	199	35	3,472	33,160	2½"
35 IBT	372.5	465.5	153	216	282	332	77	241	50	4,866	46,475	2½"
50 IBT	400	516	160	223	291	341	81	259	87	7,200	68,760	2½"

Power Packs

Hydraulic Pump Units

Christie portable hydraulic power packs are tough and high performing, and they also operate at a level that requires no hearing protection. With a 690 Bar (10,000 psi) operating pressure, these power packs give outstanding performance, whilst remaining light and portable.

- Pendant allows operator to control the tool in close proximity
- Easy view oil level gauge
- Variable pressure control for accurate torque setting
- Seamless core and high tensile reinforcement hoses (4 metre) for high safety levels



POWER PACKS

ADR70XD-LPR

All power packs are low pressure return (LPR) models. Full pressure return models are available on request.

- 2 stage pump system ensures quick location and pressure build up, with automatic change for final tightening
- 100mm diameter calibrated pressure gauge, positioned for a clear view



Air Power Packs

- Unique design feature ensures the power packs can operate in the harshest of environments for prolonged periods – severe cold and high temperatures

- Integral lubrication unit releases 1 drop of oil every 10 seconds to keep the mechanisms in good working order
- Water separator stops unwanted moisture from penetrating the unit

Model	Dimensions (mm)			Weight Kg	Tank Capacity Litres	Maximum Pressure Bar	Maximum Pressure psi	Flow Stage 1 l/min	Flow Stage 2 l/min	Hydraulic Port Size NPT	Air Capacity cfm	Desert Cooling System
	L	D	H									
ADR70MD-LPR	360	260	355	23	4.5	690	10,000	7	0.9	¼"	45-65	Yes
ADR70XD-LPR	423	268	465	39	7	690	10,000	12	1.7	¼"	80-125	Yes

Electric Power Packs

- Available in 110V and 240V versions
- Convenient power source (can also be operated from a small generator)
- Suitable for quiet and clean operating environments

See table above and below for dimensions and details

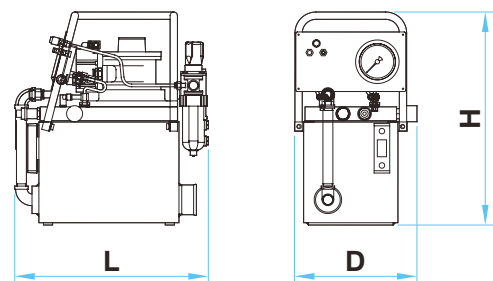

Illustration shows model ADR70XD-LPR

Model	Dimensions (mm)			Weight Kg	Tank Capacity Litres	Maximum Pressure Bar	Maximum Pressure psi	Flow Stage 1 l/min	Flow Stage 2 l/min	Hydraulic Port Size NPT	Voltages Available
	L	D	H								
EDR70M-LPR	477	236	465	29	5	690	10,000	6	0.8	¼"	110v/240v
EDR70X-LPR	514	278	540	41	7	690	10,000	10	1	¼"	110v/240v

All weights exclude hydraulic oil.

Tool Storage Solutions

A selection of trolleys and cases manufactured & supplied by W. Christie, most of which are custom built to customer's specific requirements.

From wheeled versions with lockable compartments to those with lifting lugs & grab handles, the options are endless!

- Wheeled Trolleys with brakes
- Removable Wheels
- Grab Handles
- Multiple divided sections for individual tools
- Gas spring lid systems
- Raised base for using with fork lift trucks
- Mobile benches
- Retractable wheel mechanisms
- Storage cupboards
- Fully lockable units

Large 0.9 m³
Storage Capacity

Gas Springs

Detachable
Trolley



Wheeled
with
Brakes

**We also supply
trolleys and cases
for any use...
not just tool storage!**



Tool
Sections



Retractable Wheel Mechanism

For more Tool Storage Information visit

www.wchristie.com

or call **01709 550088**



CHRISTIE
TOTAL TORQUE SOLUTIONS

W. Christie are expert providers of hire equipment for bolting and torque tightening throughout the UK.

As specialists in the field we pride ourselves on the equipment, service and advice we provide.

We will...

- Offer tool match to your specific application and give technical advice if you need it
- Guarantee all tools are individually serviced between every hire
- Provide individual calibration certificates to UK National Standards with all torque tools
- Take orders in advance and reserve equipment so you avoid disappointment
- Adapt reaction plates (at extra cost) to fit exactly as they should, reducing risk to tool and operator
- Train and assess your operators in the safe and correct use of Christie supplied equipment

HI RE SERV ICE

www.wchristie.com

HI
RE
SERV
ICE



**C-RAD
(Pneumatic)**



**BC-RAD
(Battery)**



VC-RAD (Electric)



Hydraulic Tools



**Flange
Spreaders**

**COG – Offset
Gearboxes**



**Extensive range of
Sockets & Ancillaries**

Delivery and collection service

- Equipment can be delivered and collected (same day if required).
- Provide your own transport and we will assist with loading and unloading.

For Detailed Tooling Information visit

www.wchristie.com

or call **01709 550088** to ask about a specific requirement.



Power Packs

Hyspan

PG Hydraulic Torque Tool

HYSPAN PISTOL GRIP HYDRAULIC

Up to 26 times faster than conventional ratchet style hydraulic torque wrenches.

The Hyspan Pistol Grip Torque Tool is the perfect tool for difficult and critical bolting in a wide range of operating environments, including subsea and offshore applications. This robust tool is versatile and can be used for applications other than bolting, such as the rundown of valves.



HIRE, SALES & ADVICE
01709 550088

- Repeatability of +/-4%
- Low noise level of 76 decibels
- Non-impacting and low vibration (less than 0.5 m/s²)
- Easy access to forward and reverse switching
- Oversized safety trigger
- Finished in high visibility, corrosion resistant, marine quality paint
- Integral lifting point
- Quick-release couplings
- Supplied with individual calibration certificates

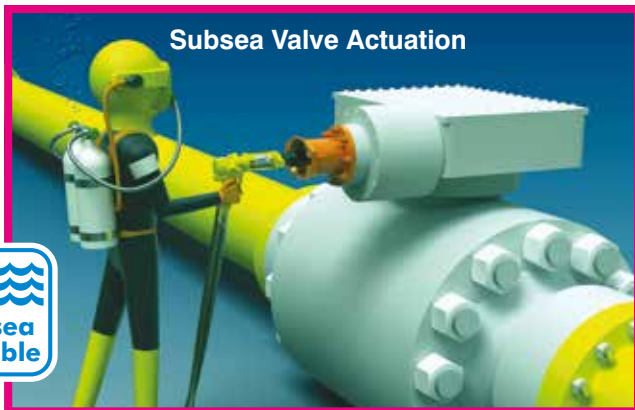

Subsea Valve Actuation



Hyspan PG powered from hydraulics of an excavator.

The flexibility of the Hyspan PG allows the tool to be operated via a power pack or from a hydraulic supply on plant vehicle hydraulics and Remote Operated Vehicles – ROVs.

Storage boxes available on request

Special models available on request

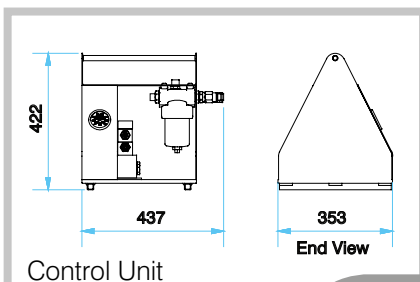
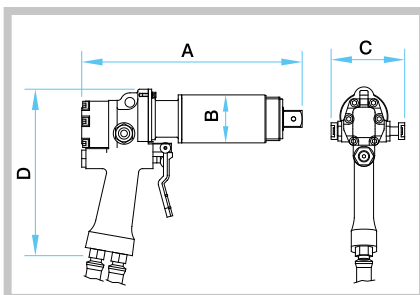

Control Unit

See table for dimensions and details

Special reactions can be designed and manufactured quickly to suit your individual applications

Model	Dimensions (mm)				Weight Kg	Speed (rpm)	Torque Range (~Nm)		Square Drive
	A	B	C	D			Min	Max	
HY10PG	335	72	110	255	7.5	28	110	1,000	¾ / 1"
HY20PG	335	72	110	255	7.5	15	190	2,000	1"
HY34PG	330	78	110	255	8.5	9.5	290	3,400	1"

Hyspan PG operates at 15-45 litres per minute flow rate.

Max. operating pressure 1,500 psi.

Hyspan

RT Remote Hydraulic Torque Tool

The Hyspan Remote Hydraulic Torque Tool is particularly suitable for those bolting jobs where remote operation is necessary, including maintenance work above and below ground, offshore, and subsea.

- Repeatability of +/- 4%
- Significantly quicker than conventional ratchet style hydraulic torque wrenches
- Remotely operated – suitable for diver inaccessible applications (e.g. deep water and hazardous)
- Non-impacting operation
- Finished in high visibility, corrosion resistant, marine quality paint
- Compatible with Remote Operated Vehicles (ROVs)
- Supplied with individual calibration certificates



HYSPAN REMOTE HYDRAULIC



Hyspan Remote in use on subsea lifting frame for positioning of concrete reinforcement blocks on underwater structure.



**HIRE, SALES
& ADVICE**
01709 550088

See table below for dimensions and details

Model	Dimensions (mm)			Weight Kg	Speed (rpm)	Torque Range (Nm)		Square Drive
	A	B	C			Min	Max	
HY10RT	72	345	n/a	<22.5	15	190	1,000	¾ / 1"
HY20RT	72	345	n/a	<22.5	8	400	2,000	1"
HY34RT	78	340	n/a	~9.0	5.5	680	3,400	1"
HY34RT-90°	280	78	255	~10.0	5.5	680	3,400	1"
HY70RT	144	395	n/a	~25.0	2.5	1,762	6,000	1½"
HY90RT	184	389	n/a	~30.0	1.8	2,710	9,500	1½"
HY110RT	216	484	n/a	~40.0	1.2	4,400	20,000	2½"

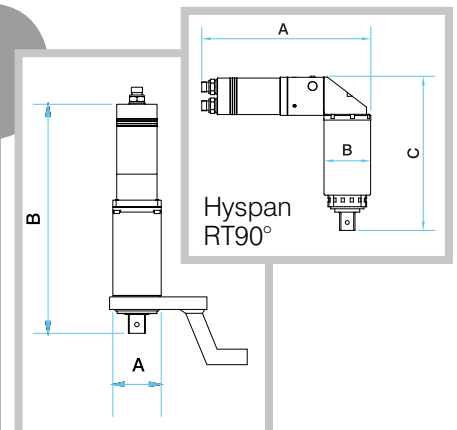

Hyspan RT operates at 7-22 litres per minute flow rate.

Max. operating pressure 2,030 psi.

www.wchristie.com

LP

Hydraulic Torque Tool

LP HYDRAULIC

Low Profile (LP) hydraulic torque tooling solves the problem of limited diameter access on flange fitting and maintenance. LP tooling can be designed to accommodate even the most severe of obstructions.

- Individually manufactured to suit specific flange applications
- Static back anchor to suit bolt centres acts as reaction
- Bi-hexagon static wrench arm



Reverse side of static wrench arm showing bi-hexagon (thin wall)

PROBLEM: Restricted Access at points A and B

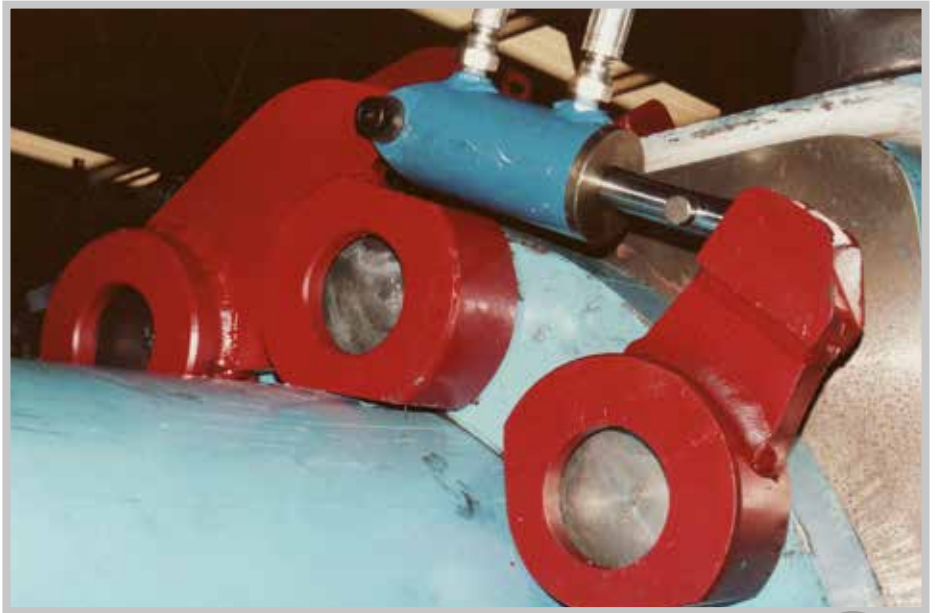
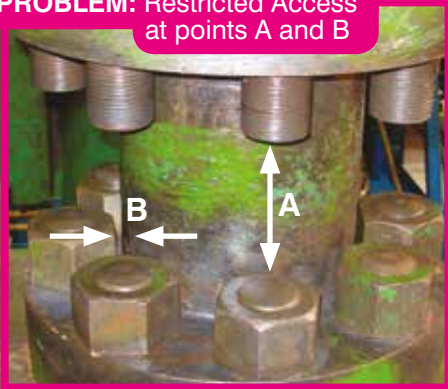

SOLUTION: Hydraulic LP Torque Tool

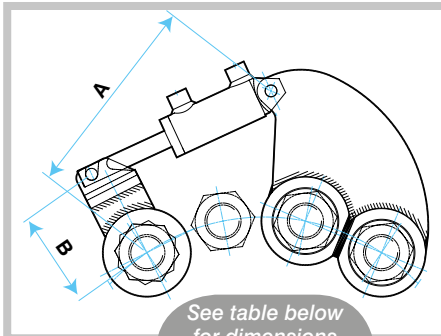

See table below for dimensions and details

HIRE, SALES & ADVICE
01709 550088

Model	Dimensions		Torque Capacity		Max. Operating Pressure
	A mm	B mm	Push Nm	Pull Nm	
LP3	213	102	4,000	2,237	10,000
LP5	381	152	10,778	3,254	10,000
LP7	416	228	25,218	9,084	10,000
LP9	510	305	59,656	30,506	10,000

LH

Hydraulic Torque Tool

Low Height (LH) hydraulic torque tooling solves the problem of limited height access on flange fitting and maintenance by making the reaction point sit firmly on the rim of the flange.



HIRE, SALES & ADVICE
01709 550088

LH HYDRAULIC



- Available with static or ratchet lever arms
- Can be supplied with reaction arms up to 120mm across flats
- Lever arms can be built to specific applications

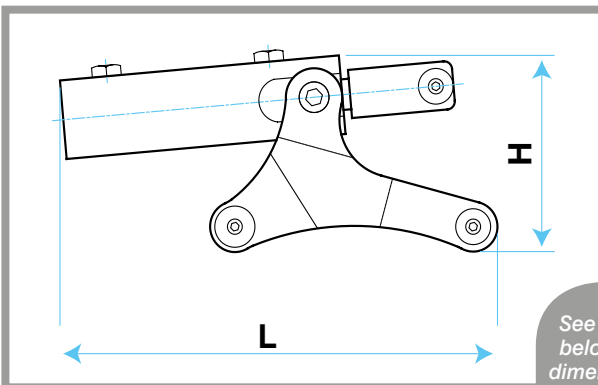

See table below for dimensions and details

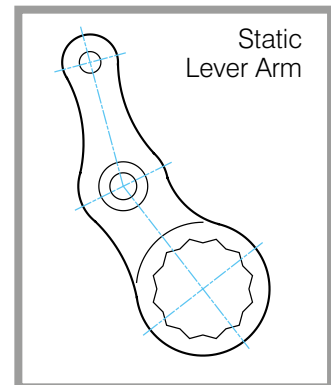
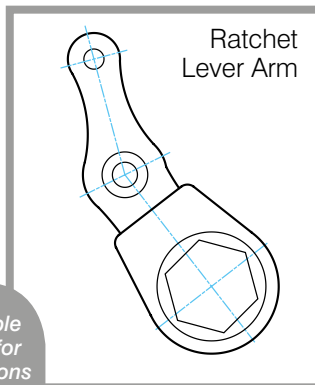

Model	Dimensions		Weight	Max. A/F		Torque Capacity	Max. Operating Pressure
	H	L		Ins.	mm		
	mm	mm	Kg			Nm	Psi
LH20K	127	280	6.5	2"	51	2,720	10,000
LH30K	140	304	9	2¾"	70	7,400	10,000
LH60K	152	330	14	3½"	90	14,800	10,000
LH100K	216	381	26	4½"	120	24,000	10,000

CR

Heavy Duty Hydraulic Torque Tool

CR HYDRAULIC

The square drive design of the CR range of torque tools enables the easy fitment of impact sockets and ancillaries, making them ideal for tightening and un-tightening bolts of all sizes. The steel construction means they are suitable for the toughest of bolting applications.

- 12 position reaction
- Reversible operation
- Rapid double action operation
- Accurate to within +/-3%
- Corrosion resistant
- Conforms to European Standards for subsea and underground work
- Robust 100% steel construction



The CR tool is available with optional swivel couplings and special reactions

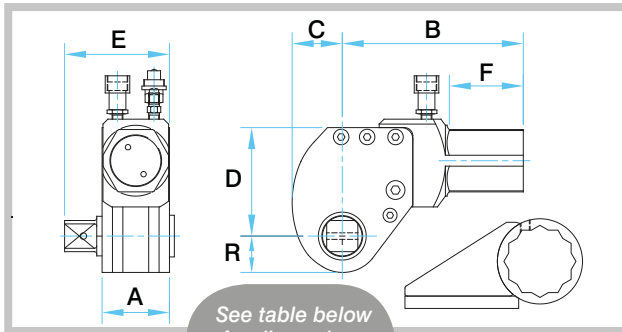

See table below for dimensions and details

Smart Socket

Transducerized hexagonal socket for torque verification on non-impacting square drive torque tools

Refer to page 26 of our Hand Held Torque Tools brochure or visit our website for further details.



Model	Dimensions (mm)							Weight Kg	Maximum Torque Nm	Square Drive
	A	B	C	D	E	F	R			
CR 1	42	124	32	65	73	45	24	4	1,360	¾"
CR 1.5	50	143	30	65	90	51	25	6	2,040	1"
CR 3	52	175	40	92	92	57	35	8	4,488	1"
CR 5	65	180	50	97	120	60	41	13	7,888	1½"
CR 7	65	207	54	112	120	76	45	16	10,060	1½"
CR 11	83	222	61	133	138	89	45	22	14,960	1½"
CR 15	95	230	70	140	172	82	52	31	20,400	2½"
CR 20	97	265	74	157	168	102	62	44	28,560	2½"
CR 30	115	290	73	175	189	109	69	54	43,520	2½"
CR 50	144	320	93	200	249	124	86	103	68,000	3½"
CR 60	160	388	110	225	254	150	94	146	81,350	3½"
CR 80	173	416	115	258	278	178	100	178	108,800	3½"

HIRE, SALES & ADVICE
01709 550088

CCR

Heavy Duty Hydraulic Torque Tool

The open hexagon design of the CCR range of torque tools gives direct fitting onto the nut or bolt head. This tooling with robust steel construction is especially suited to applications with limited overhead access or with fasteners with excessive thread protrusion.



CCR HYDRAULIC

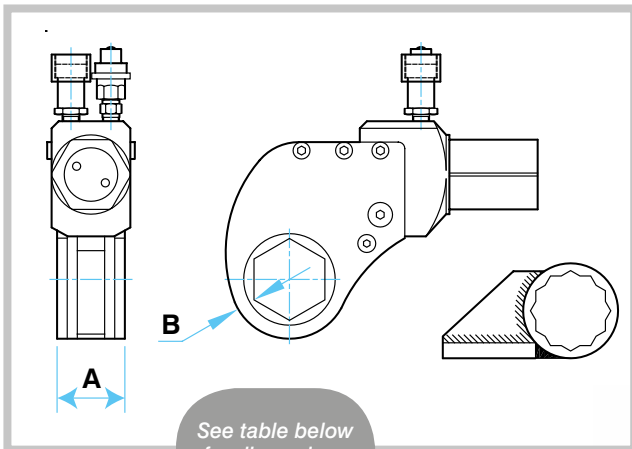

See table below for dimensions and details

- 12 position reaction
- Reversible operation
- Rapid double action operation
- Accurate to within +/-3%
- Corrosion resistant
- Conforms to European Standards for subsea and underground work
- Robust 100% steel construction

HIRE, SALES & ADVICE
01709 550088

The CCR tool is available with optional swivel couplings and special reactions

Model	Dimensions (mm)		Maximum A/F		Maximum Torque Nm
	A	B	Inch	mm	
CCR 1	38	11	1½"	41	1,360
CCR 1.5	41	12	2¾"	55	2,040
CCR 3	52	17	2¾"	65	4,488
CCR 5	58	16	3"	75	7,888
CCR 7	64	18	3½"	80	10,060
CCR 11	82	20	4½"	120	14,960
CCR 15	96	22	4½"	120	20,400
CCR 20	100	25	5"	130	28,560
CCR 30	120	30	6½"	155	43,520
CCR 50	147	38	8"	205	68,000
CCR 60	160	43	9"	230	81,350
CCR 80	180	51	10"	250	108,000



THE WEDGE

**HIRE, SALES
& ADVICE**
01709 550088

Flange Spreading Wedges

FLANGE SPREADING WEDGES



FUNCTIONAL

The Flange Spreaders can be used during:

- Commissioning
- Construction
- Routine maintenance
- Shutdowns/outages
- Testing
- Valve change-outs

SPECIAL FEATURES

- Unique interlocking first step
- Deep 15mm secure hold on first step
- Requires access gap of only 6mm
- Robust lightweight tool
- Automatic mechanical retraction
- Environmentally friendly

OPERATING BENEFITS

- Secure hold on each step
- Quick and easy operation
- Saves time
- Safe operation
- Portable

Mechanical Flange Spreader

Spreading Force: = 9.4 T (94 kN)

Kit components:

- 1 x WC9TM Wedgehead
- 1 x Torque wrench with 22 mm socket
- 1 x Safety block
- 1 x Instruction manual
- 1 x Cardboard packaging



Integral Hydraulic Flange Spreader

Spreading Force: = 14.5 T (145 kN)

Kit components:

- 1 x WC14.5T Wedgehead
- 1 x 10,000 psi (700 bar) 10 T integral hydraulic pump/cylinder
- 1 x Safety block
- 1 x Carry strap
- 1 x Instruction manual
- 1 x Robust carry case



Hydraulic Flange Spreader

Spreading Force: = 15.5 T (155 kN)

KIT OPTIONS:

- See next page for kit options and components.
- Mini Kit
- Standard Kit
- Maxi Kit



It is recommended that tools are used in pairs

ACCESSORIES

- 2 x stepped blocks
- 2 x M6 x 10mm countersunk screws
- 1 x 4mm hex. key



Lesser penetration, greater spread
Sold in pairs

Call for PRICES or a FREE DEMONSTRATION on:
01709 550088

The Wedge



MINI KIT COMPONENTS

- 1 x WC15TE Wedgehead
- 1 x 10,000 psi Hydraulic Cylinder
- 1 x Safety Block
- 1 x Instruction Manual

STANDARD KIT COMPONENTS

- 1 x WC15TE Wedgehead
- 1 x Pair of Stepped Blocks
- 1 x 10,000 psi 2m Hydraulic Hose
- 1 x 10,000 psi Hydraulic Cylinder
- 1 x 10,000 psi HP350S Sealed Hand Pump with Gauge
- 1 x Safety Block
- 1 x Instruction Manual
- 1 x Robust Carry Case

MAXI KIT COMPONENTS

- 2 x WC15TE Wedge Heads
- 2 x Pairs of Stepped Blocks
- 2 x 10,000 psi 2m Hydraulic Hoses
- 2 x 10,000 psi Hydraulic Cylinders
- 1 x 10,000 psi HP350D Sealed Hand Pump with Gauges
- 2 x Safety Blocks
- 1 x Instruction Manual
- 1 x Robust Carry Case



TOOL DIMENSIONS - CLOSED

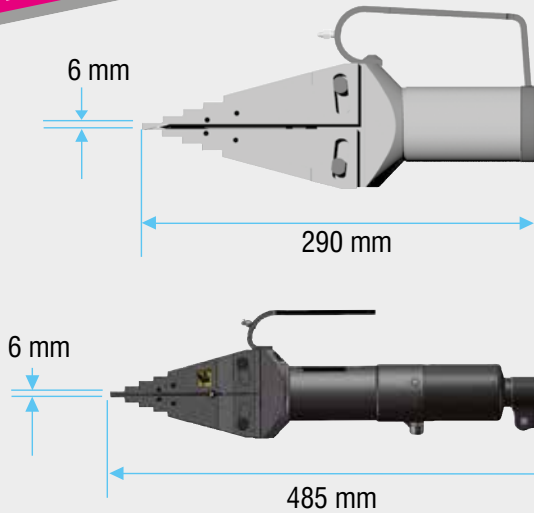

TOOL DIMENSIONS - OPEN

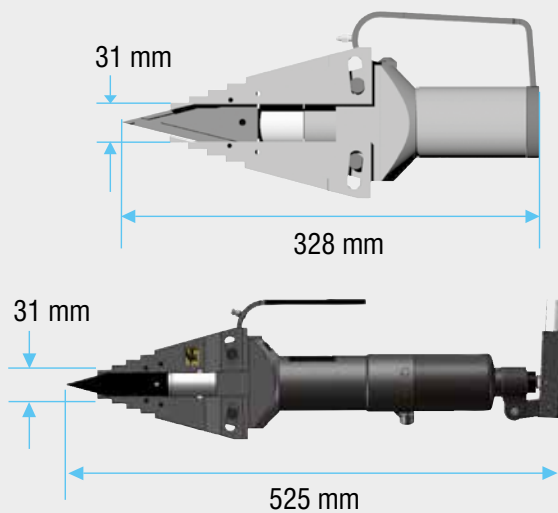

Other Product Ranges Available

Flange Alignment Tools



Zero-Gap Spreading Tools



Hydraulic Vertical Lifting Wedge



Mini Gap Flange Spreader



Backing Tool

Hands Free Backing Tool

BACKING TOOL

The hands free Backing Tool is safer than traditional methods of bracing the nut in flange work, minimising the risk of trapped hands and fingers.

- Adjustable retaining ball to hold Backing Tool to nut
- Single cast construction for strength
- Fixing ring for attaching Lanyard, to stop Backing Tool from falling
- A bi-hexagon / 12 point design makes it easy to locate on the nut
- Backing Tool sizes are imperial to suit UNC flange bolts



HIRE, SALES & ADVICE
01709 550088



Individual Backing Tools are available in a range of sizes from $\frac{7}{8}$ " A/F ($\frac{1}{2}$ " UNC) to $5\frac{3}{8}$ " A/F ($3\frac{1}{2}$ " UNC).

Kits also available:

6 Piece Set

includes

$\frac{7}{8}$ ", $1\frac{1}{16}$ ", $1\frac{1}{4}$ ", $1\frac{7}{16}$ ",
 $1\frac{5}{8}$ ", $1\frac{13}{16}$ "

8 Piece Set

includes

$\frac{7}{8}$ ", $1\frac{1}{16}$ ", $1\frac{1}{4}$ ", $1\frac{7}{16}$ ",
 $1\frac{5}{8}$ ", $1\frac{13}{16}$ ", 2 ", $2\frac{3}{16}$ "

Other kit variations available on request.



Problems: Flogger Method

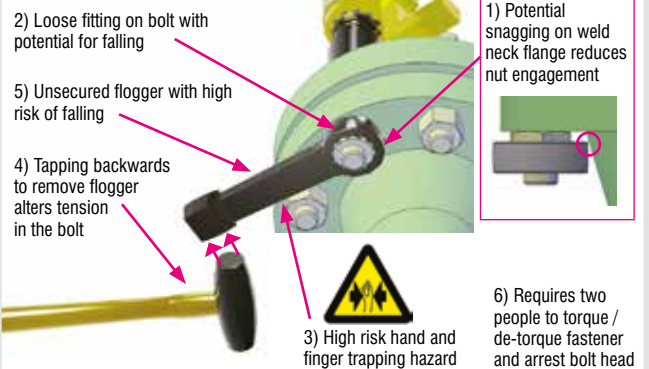

Solution: Backing Tool

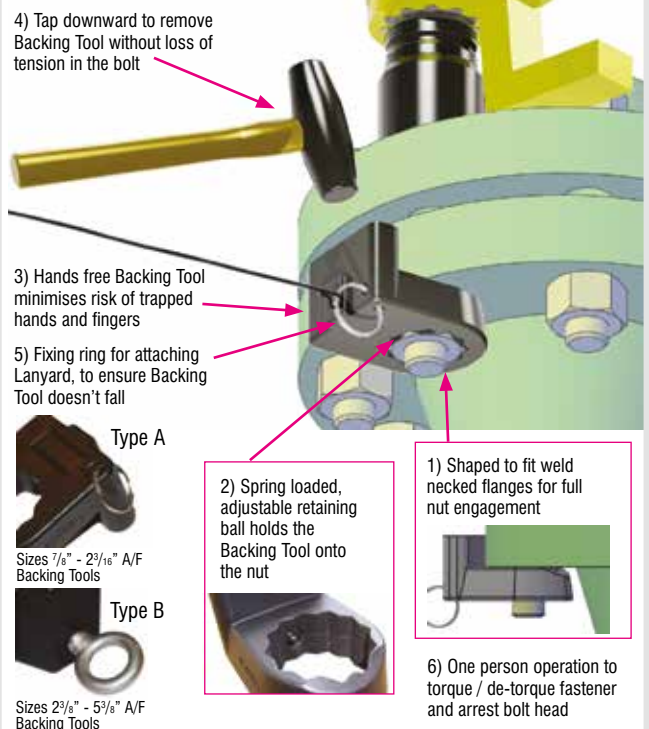

Flange Alignment Pins

FLANGE ALIGNMENT PINS

The easy and safer way to align flanges

- Tapered shaft eliminates need for hammering and prying when lining up flange bolt holes
- Compensates for up, down and rotational misalignment
- Size range: 3/8" to 3-5/8"
- Available in regular or extra-long versions
- Sold individually or in sets



Flange Alignment Pin

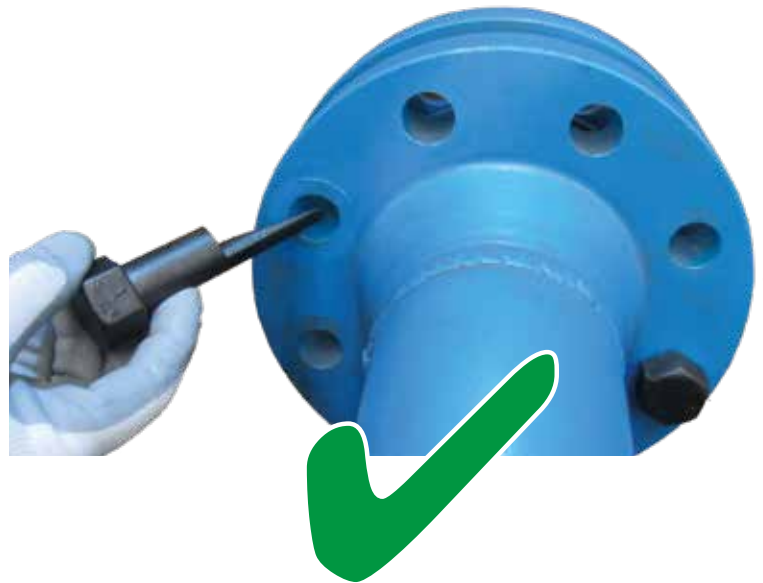
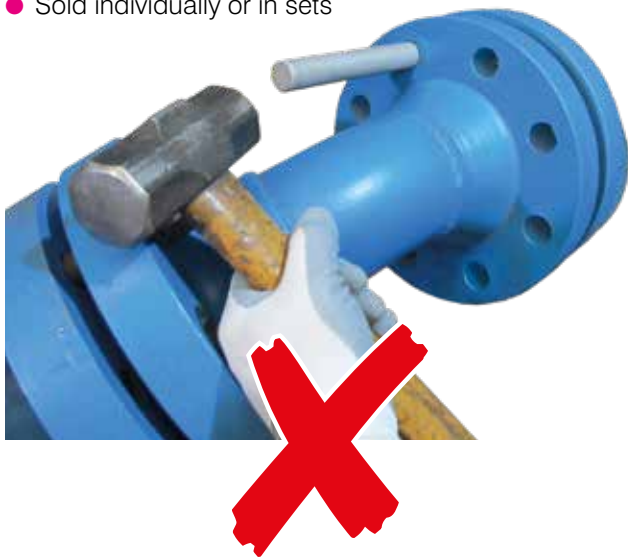

Safer option

Does not require the use of a hammer

Part No	Sets with Case	
	2 of Each Size	Weight (Kg)
FTS24	3/4", 7/8", 1"	3.60
FTS26	3/4", 7/8", 1", 1-1/8"	5.00
FTS28	3/4", 7/8", 1", 1-1/8", 1-1/4"	6.80
FTS212	3/4", 7/8", 1", 1-1/8", 1-1/4", 1-3/8"	10.00
FTS1426	1-1/2", 1-5/8", 1-3/4", 2"	22.70

Part No	Sets with Case - Extra long	
	2 of Each Size	Weight (Kg)
FTS24L	3/4", 7/8", 1"	5.90
FTS26L	3/4", 7/8", 1", 1-1/8"	8.20
FTS28L	3/4", 7/8", 1", 1-1/8", 1-1/4"	9.50
FTS212L	3/4", 7/8", 1", 1-1/8", 1-1/4", 1-3/8"	14.50

Individual Flange Alignment Pins also available.

- Please contact us for details of the full range of sizes.

 **01709 550088**



Flange Alignment Pins and Case

Order **FREE** the latest
Engineers Friend
Booklet and Poster



CHRISTIE
 TOTAL TORQUE SOLUTIONS

Visit www.wchristie.com
 or call **01709 550088**

To **download our brochures** visit our website
www.wchristie.com and click **brochures/tech.data**

Alternatively printed versions can be
 requested via our website or by
 contacting us on **01709 550088**



W. CHRISTIE (INDUSTRIAL) LTD,
 Christie House, Meadowbank Road, Rotherham, South Yorkshire, S61 2NF UK
Tel: +44(0)1709 550088 **Email: info@wchristie.com**
Visit: www.wchristie.com

No statement or data within this literature is warranted or guaranteed to be accurate.

REGISTERED OFFICE:
 UNIT F7, FESTIVAL BUSINESS CENTRE, 150 BRAND STREET, GLASGOW, G51 1DH, SCOTLAND
 Tel: +44(0)141 427 9801 • Fax: +44(0)141 427 9802 • Email: WCHRISTIEGLW@BTCONNECT.COM
 REGISTRATION NO: SC 035247

